

REDLINE / WEBER CARBURETORS

40-45 DCOE (Typical)

PERFORMANCE SERIES
1950-174 40 DCOE
19600-060 45 DCOE

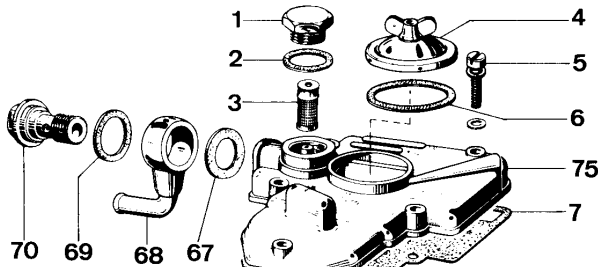

NOTE:

There have been two key productions of the DCOE they can be distinguished by the float style
Early w/brass floats
Late w/nitrofil Black floats

(Picture used is late style)

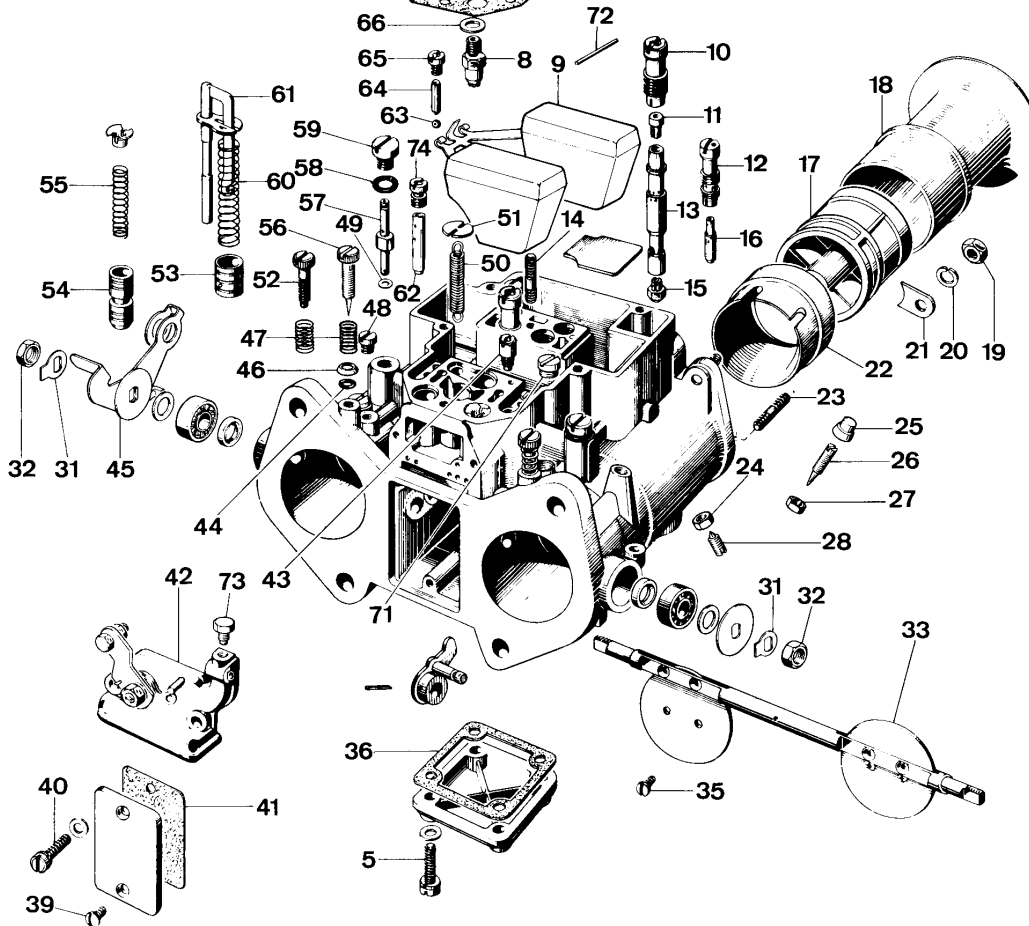

Rebuild Kit

92-3246-05
Early style kit
w/o float

92-1514-05
Late style kit
w/o float
Use with all turbo
applications

For mounting use
Soft mount O ring kit
99005-145
fits 40-45 DCOE

Float Settings

Early style brass float
8 to 8.5mm (at radius)

Late style plastic float
12.5 to 13mm at
extreme tip of float

All settings are gasket
to float

Float setting notes

1. Fuel pressure is critical to float spillage 2.5 to 3 lbs.
2. For aggressive off-road use float drop should be limited to 1 to 1.5 mm max drop of tap for float needle

KEY CALIBRATED PARTS

- 8) 79503-xxx Needle & Seat
- 9) 41030-005 Brass Float (early style)
- 9) 41030-034 Nitrofil Float (late style)
- 15) 73401-xxx Main fuel Jet
- 11) 77401-xxx Main Air corrector Jet
- 16) xxxxx-xxx Idle Jet Idle jet has both a size and f number designation call for part no
- 57) 76801-xxx Accelerator pump Jet
- 43) 79701-xxx Accelerator by-pass Jet