

REDLINE / WEBER CARBURETORS

40 44 48 IDF- XE

PRO SERIES
18950-138 40 IDF 70
18890-030 44 IDF 71
19030-021 48 IDF 6

Late style IDF XE shown
 Early style can be identified by its cam and roller style accelerator pump action.
 Redline Weber rebuild kits contain both styles of pump diaphragms

VIEW
40 SERIES
TOP

VIEW
44 & 48 SERIES
TOPS

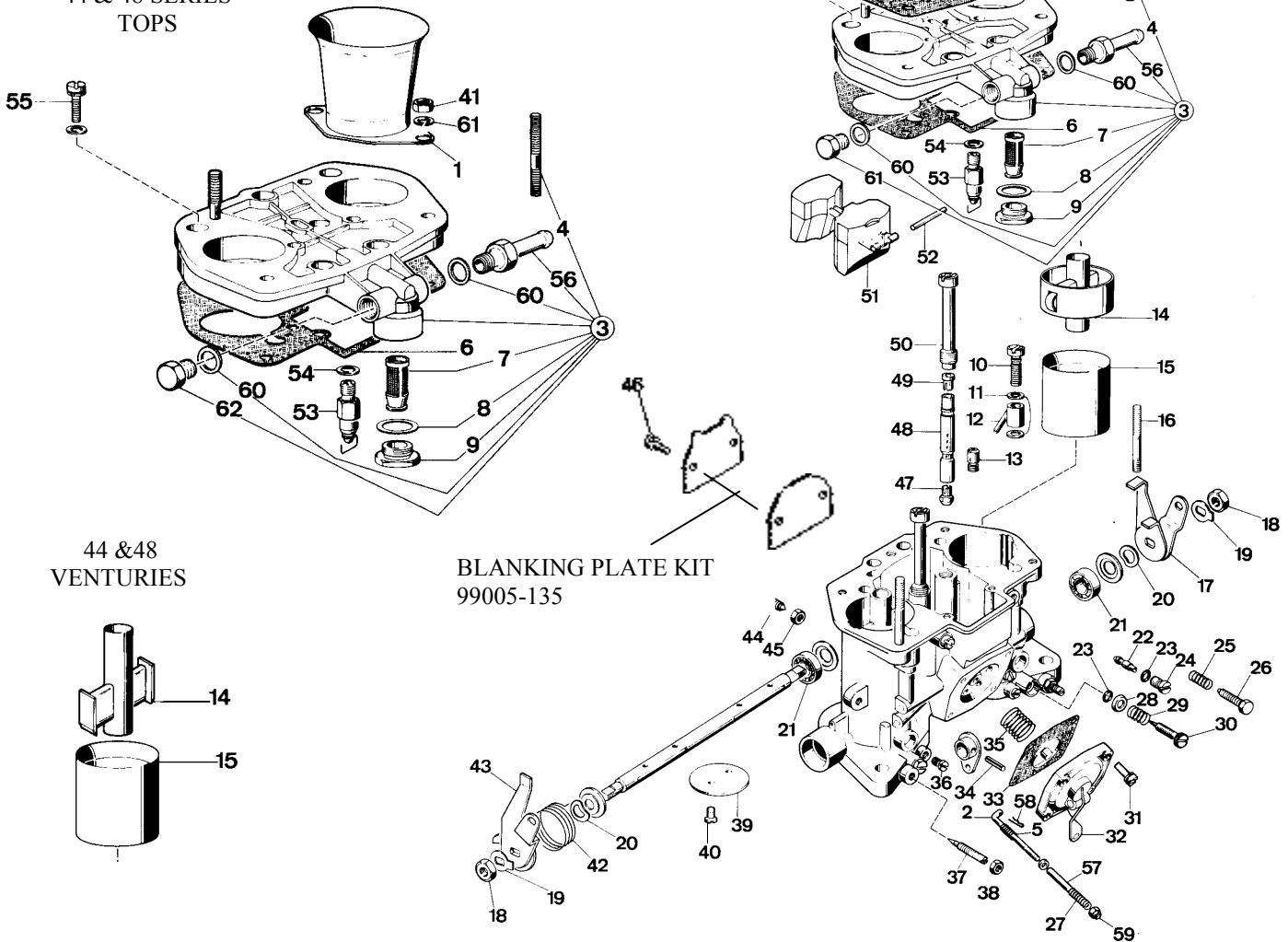

44 & 48
VENTURIES

BLANKING PLATE KIT
99005-135

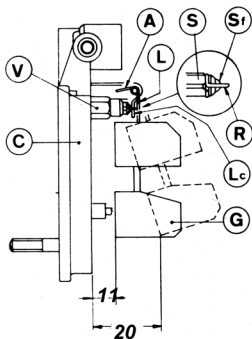

Float setting notes

15) 41030-008 Float

1. Fuel pressure is critical to spillage 2.5 to 3 PSI.
2. For aggressive off-road use float drop should be limited to 15 .5 mm max dr

KEY CALIBRATED PARTS

- 50) 52580-006 Extended Jet holder
- 53) 79511-xxx Needle & Seat (steel)
79519-xxx Viton performance Needle & Seat
- 19) 73401-xxx Main Jet
- 94) 77401-xxx Air corrector Jet
- 34) 74405-xxx Idle Jet
- 13) 79701-xxx Pump by-pass (use 000 for performance)
- 96) 76210-xxx Accelerator pump Jet
- 33) 47407-207 Accelerator pump diaphragm XE style
47407-027 Accelerator pump diaphragm early style

Rebuild kit 92-3240-05